

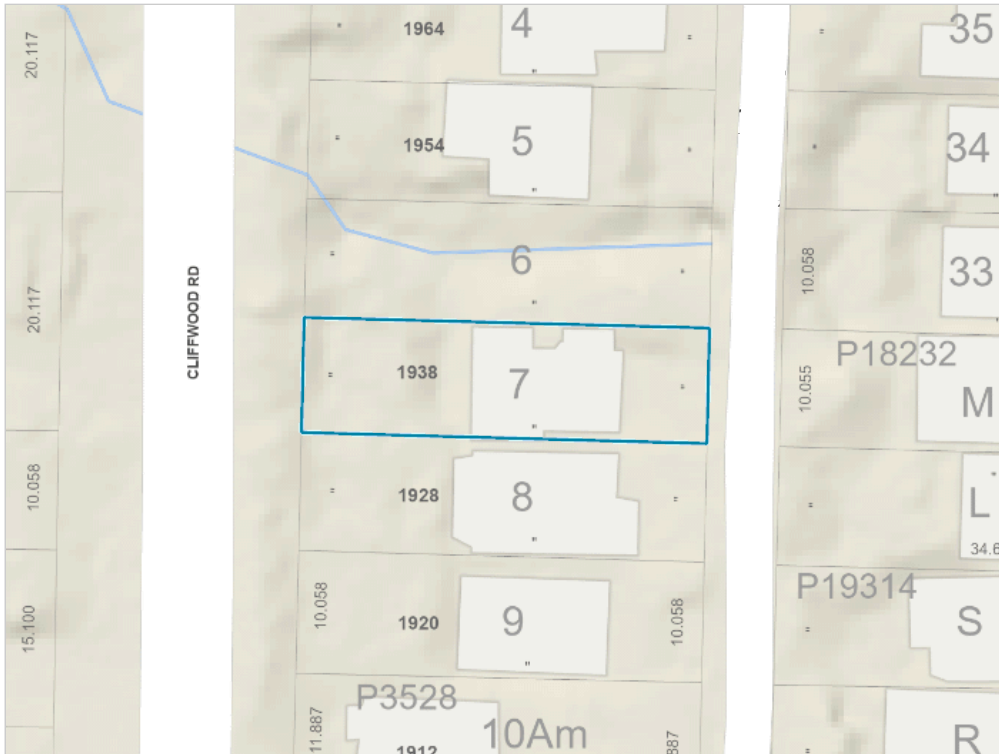

DNV Property Information Report



1938 CLIFFWOOD RD

Legal

Legal Description

LOT 7 OF LOT 6 BLOCK 4 DISTRICT LOT 626
PLAN 3528

LTOPID

010-172-475

Folio

0446-9300-1

Owner Type

PRIVATE

Property Type

FEE SIMPLE

Leased Property

No

Geography

Area

334.00 sq m (+/- 5%)

Elevation

45.30 m above sea level

Latitude, Longitude

49.32432° N, 122.95443° W

Snow Load Zone

10 to 60 m, 2.8 Kpa

Building

Building Name

BUILDING

Date Built

1931

Type

SINGLE FAMILY

Subtype

DETACHED

Heritage

Not identified as a heritage property

Solar Heating Potential Rating

★★★★☆

Amount of Roof Facing South

68%

Average Solar Energy

750.07 MJ

Average Optimal Solar Energy

33.28 MJ

Assessment

Building Value

\$47,600

Land Value

Services

\$1,487,000

Garbage Days

Total Value

Friday, November 8
Monday, November 18

\$1,534,600

Snow Clearing Routes

Nearby

• PRIORITY THREE

Recreation Centre

RON ANDREWS COMMUNITY RECREATION CENTRE

Hydrant

18 m

Library

PARKGATE LIBRARY

Regulatory

Zoning

• RS4: SINGLE-FAMILY RESIDENTIAL 6000 ZONE (550 SQ.M.), RS

Firehall

FIREHALL #4

DPA

• STREAMSIDE PROTECTION
• WILDFIRE HAZARD: WILDFIRE INTERFACE AREA

Hospital

BUILDING

Neighbourhood

DEEP COVE

Police Station

GERRY BREWER BUILDING (RCMP & NSEMO)

Elementary School Catchment

COVE CLIFF

Secondary School Catchment

SEYCOVE

Electoral Riding

NORTH VANCOUVER - SEYMOUR

LIABILITY: The District of North Vancouver makes no representation or warranties whatsoever with respect to: the accuracy; the content; or the quality of information found on this product or service. The responsibility for confirming the accuracy, content and quality of this product or service rests entirely with the user. The District of North Vancouver assumes no responsibility for damages, losses, business interruption or expenses incurred as a result of using this product or service.

GEOweb

District of North Vancouver GIS
geoweb.dnv.org
gis@dnv.org
(604) 990 2311